

MECHANICAL CONNECTORS AND LUGS FOR ALUMINUM FLEXIBLE CONDUCTORS FOR LOW AND MEDIUM VOLTAGE ALUMINIUM CABLES

KEY FEATURES

- Easy and secure connection system for Aluminum flexible cables tested to IEC-61238-1 Class A.
- New patented two step shear off bolts provide pre-determined torque & ensure reliable and secure contact without damaging fine Aluminum strands.
- Easier and faster installation without application tooling and reduced number of bolts.
- To be available for cable cross sections 70 mm² through 500 mm².
- Dual range connectors available for connecting Cu - Al and Al - Al combinations for class 5 & class 2 conductors.

TE Connectivity's (TE) BSMB and BLMT-FLEX mechanical connectors and lugs are designed for use in low and medium voltage applications up to 42 kV. All products consist of high tensile aluminium tin-plated body and shear-head bolts. Made of special aluminium alloy, the new patented two step shear off bolts are irremovable once their heads have been sheared off. The internal surface of the conductor holes are grooved. Lugs are suitable for outdoor and indoor applications and are available with different palm hole sizes.

Customers can count on consistent, high quality products, driven by TE's proven innovation and backed by our extraordinary customer support.

Mechanical Connectors and Lugs

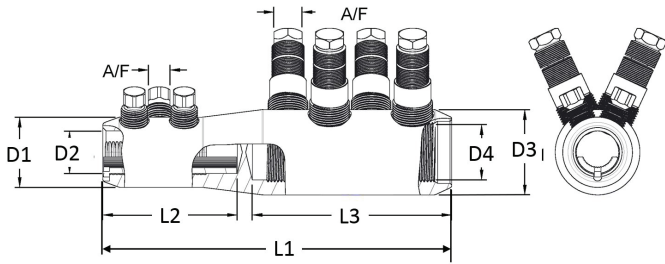

PRODUCT SELECTION INFORMATION

Description	Cross sectional range class 2 conductors (mm ²)	Cross sectional range class 5 flexible conductors (mm ²)	Dimensions (mm)								Contact bolts quantity		Head size AF (mm)	
			L1	L2	L3	D1	D2	D3	D4	Side 1	Side 2	Side 1	Side 2	
BSMB-150/400-400-FLEX	150/400	300/400	210	80	120	42	25.5	51	33	3	4	13	17	

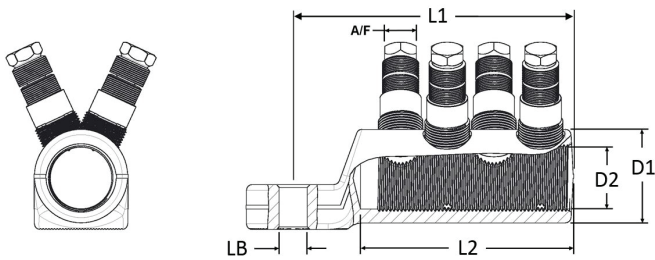

PRODUCT SELECTION INFORMATION

Description	Cross sectional range class 5 conductors (mm ²)	Palm hole diameter (mm) LB	Dimensions (mm)				Contact bolts quantity	Head size AF (mm)
			L1	L2	D1	D2		
BLMT-400 FLEX-15	300/400	15	150	115	51	33	4	17
BLMT-400 FLEX-17	300/400	17	150	115	51	33	4	17
BLMT-400 FLEX-21	300/400	21	150	115	51	33	4	17

te.com/energy

©2016 TE Connectivity Ltd. family of companies. All Rights Reserved. EPP-EPP-2781-DDS-5/16-EMEA-BSMS-BLMT-SIMEL

TE Connectivity and TE Connectivity (logo) are trademarks. Other logos, product and/or company names might be trademarks of their respective owners. While TE has made every reasonable effort to ensure the accuracy of the information in this brochure, TE does not guarantee that it is error-free, nor does TE make any other representation, warranty or guarantee that the information is accurate, correct, reliable or current. TE reserves the right to make any adjustments to the information contained herein at any time without notice. TE expressly disclaims all implied warranties regarding the information contained herein, including, but not limited to, any implied warranties of merchantability or fitness for a particular purpose. The dimensions in this catalog are for reference purposes only and are subject to change without notice. Specifications are subject to change without notice. Consult TE for the latest dimensions and design specifications.

FOR MORE INFORMATION: TE Technical Support Centers

USA:	+ 1 800 327 6996
France:	+ 33 380 583 200
UK:	+ 44 0870 870 7500
Germany:	+ 49 896 089 903
Spain:	+ 34 916 630 400
Italy:	+ 39 333 250 0915
Benelux:	+ 32 16 351 731
Canada:	+ 1 (905) 475-6222
Mexico:	+ 52 (0) 55-1106-0800
Latin/S. America:	+ 54 (0) 11-4733-2200
China:	+ 86 (0) 400-820-6015